

3. REPAIR PARTS LIST

DISASSEMBLY
(ENGLISH)

DISASSEMBLY
(JAPANESE)

NOTE:

- XX and -X mean standardized parts, so they may have some difference from the original one.
- Items marked “*” are not stocked since they are seldom required for routine service. Some delay should be anticipated when ordering these items.
- The mechanical parts with no reference number in the exploded views are not supplied.

3-1. EXPLODED VIEWS

ns: not supplied

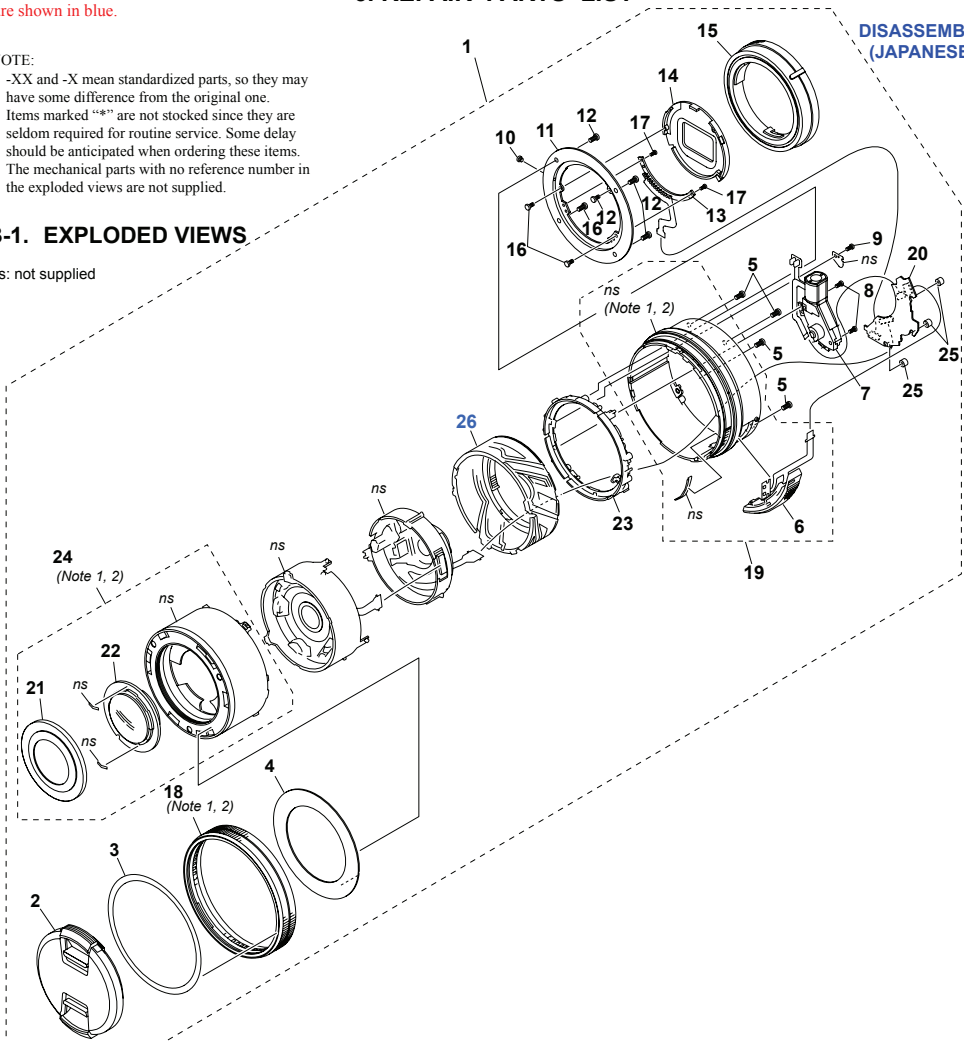

Ref. No.	Part No.	Description
1	A-1906-355-A	OPTICAL BLOCK FOR SERVICE (C) (BLACK)
1	A-1906-399-A	OPTICAL BLOCK FOR SERVICE (D) (SILVER)
2	X-2584-679-1	FRONT U_ASSY(D40.5)
3	4-426-830-01	FRONT COVER (BLACK)
3	4-426-830-11	FRONT COVER (SILVER)
4	4-426-795-01	1ST FRONT PLATE
5	4-300-115-11	TAPPING (1.7) (CH)
6	A-1899-285-A	SWITCH ASSY(SI) (SILVER)
6	A-1897-556-A	SWITCH ASSY (BLACK)
7	1-855-248-11	MOTOR GEARED BLOCK (9109)
8	4-300-106-01	BTITE (1.4) (CH))
9	3-254-135-01	SCREW (B1.4)
10	4-298-699-01	STOPPER SCREW (CH)
11	4-430-576-01	MOUNT (EN)
12	4-298-700-01	SCREW, TAPPING B2 (CH)

Ref. No.	Part No.	Description
14	4-426-840-01	REAR LIGHT SHIELD BARREL
15	4-159-701-01	REAR LENS CAP
16	4-300-118-01	SCREW (P1.4) (CH)
17	4-299-469-01	SCREW M1.4 (CH)
18	X-2585-593-1	OPERATION BARREL ASSY (BLACK) (Note 1, 2)
18	X-2585-673-1	OPERATION BARREL ASSY (SI) (SILVER) (Note 1, 2)
19	A-1897-555-A	OUTER BARREL ASSY (BLACK)
19	A-1899-284-A	OUTER BARREL ASSY (SI) (SILVER)
20	A-1897-560-A	CL-1004 BOARD, COMPLETE
21	4-426-793-02	1ST LIGHT SHIELD RING
22	X-2585-586-1	1ST LENS ASSY
23	4-426-821-02	STATIONARY BARREL
24	A-1897-552-A	1 GROUP BLOCK ASSY (BLACK) (Note 1, 2)
24	A-1899-283-A	1 GROUP BLOCK ASSY (SI) (SILVER) (Note 1, 2)

13 X-2585-594-1 BOX ASSY, BL CONTACT
 SELP1650 (E 3.5-5.6/PZ 16-50 OSS) (E PZ 16-50mm F3.5-5.6 OSS)

Note 1: Notes for Removing the Outer Barrel Assy. HELP05

When the Outer Barrel Assy is removed, the Optical Unit may be disassembled. To prevent the Optical Unit from being disassembled, be sure to follow the procedure below for removing the Outer Barrel Assy.

- 1) Remove the Operation Barrel Assy first referring to (Note 2).
- 2) Remove the four screws of the Outer Barrel Assy with the Optical Unit set at the WIDE end.
- 3) Remove the Outer Barrel Assy while maintaining the WIDE end state of the Optical Unit.

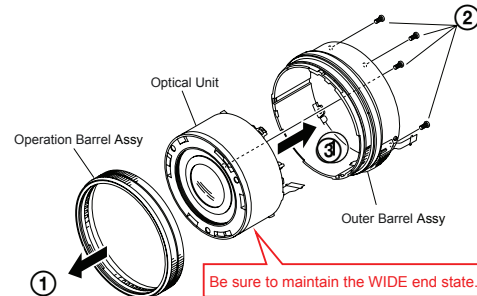

Note 2: Removing the Operation Barrel Assy

- 1) Insert a lens jig (Chip B) into arbitrary two holes out of three holes of the Operation Barrel Assy.
- 2) Turn the outside of the Operation Barrel Assy to find the position where the tip of Chip B can be fully inserted, and check that the outside and the inside of the Operation Barrel Assy turn simultaneously.
- 3) Turn the outside and the inside of the Operation Barrel Assy counterclockwise until you feel a click and remove the Operation Barrel Assy.

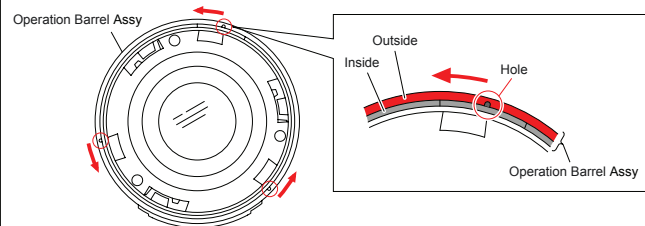

3-2. SUPPLIED ACCESSORIES

Checking supplied accessories.

• EXCEPT J MODEL
ACCESSORIES

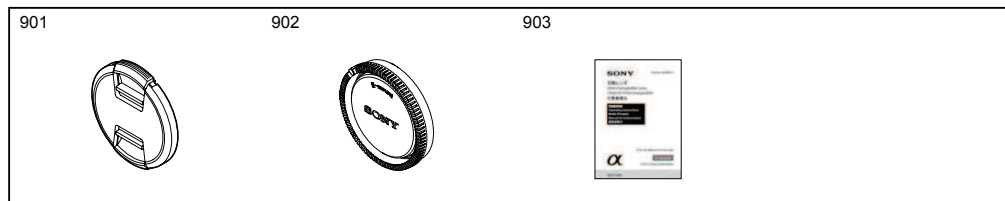

Ref. No.	Part No.	Description
901	X-2584-679-1	Front lens cap
902	4-159-701-01	Rear lens cap
903	4-434-750-01	Instruction Manual (JAPANESE, ENGLISH, FRENCH, SPANISH, SIMPLIFIED CHINESE)
* 903	4-434-750-11	Instruction Manual (GERMAN, DUTCH, SWEDISH, ITALIAN, PORTUGUESE)
* 903	4-434-750-21	Instruction Manual (RUSSIAN, UKRAINIAN, TRADITIONAL CHINESE, KOREAN, ARABIC)

3-2. 付属品

付属品を確認してください。

• J MODEL
付属品

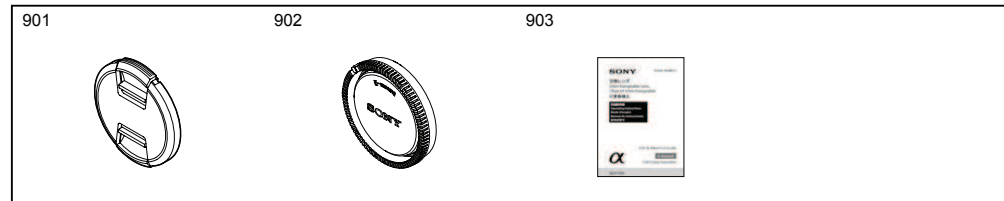

Ref. No.	Part No.	Description
951	X-2584-679-1	レンズフロントキャップ
952	4-159-701-01	レンズリヤキャップ
953	4-434-750-01	取扱説明書 (日本語, 英語, フランス語, スペイン語, 中国語 (簡体字))
* 953	4-434-750-11	取扱説明書 (ドイツ語, オランダ語, スウェーデン語, イタリア語, ポルトガル語)
* 953	4-434-750-21	取扱説明書 (ロシア語, ウクライナ語, 中国語 (繁体字), 韓国語, アラビア語)